

## APC 6

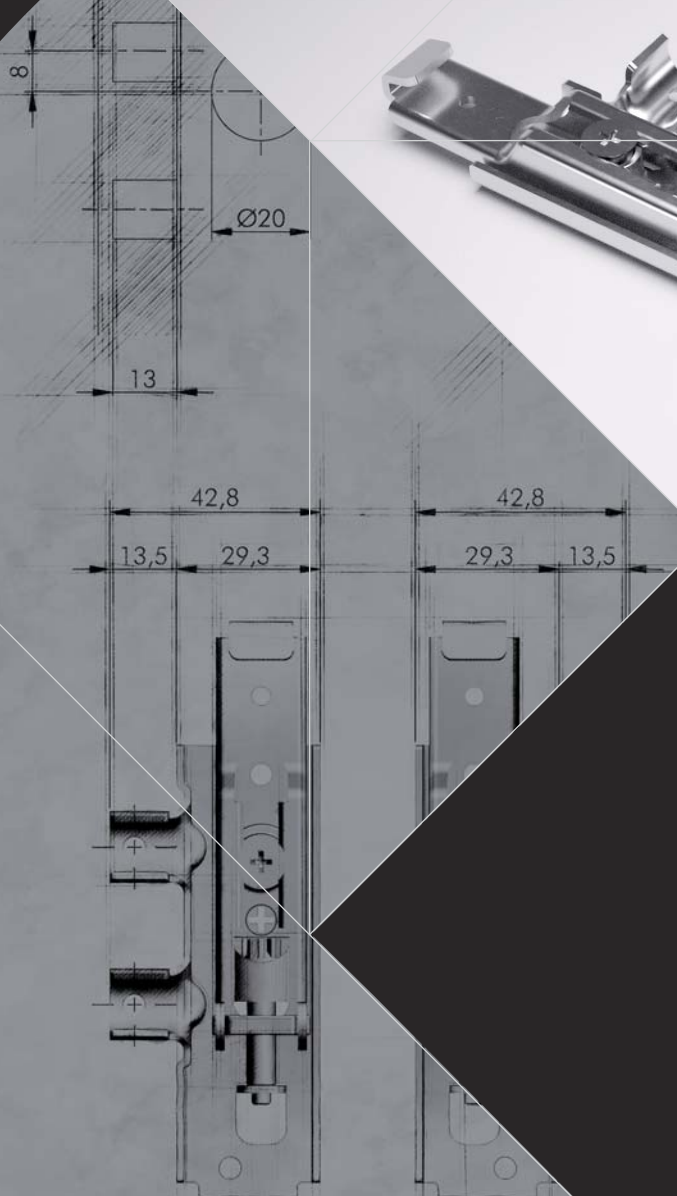

HANGERS

## APC 1, APC 3, APC 4, APC 6 LIVING SETTINGS



APC 1



APC 4



APC 3



APC 6



## APC 6

**APC6** is a left/right invisible cabinet hanger with 2 semi-circular pins Ø15 mm especially conceived for automatic assembly.

**APC6** grants high performances even without its fixing on the top panel. It can be installed on cabinets with side panels of minimum 16 mm and with a minimum sanitary gap of 15 mm.

**APC6** allows a vertical adjustment up to 18 mm and an in-depth adjustment of maximum 31 mm. The adjustments can be carried out from the inside of the cabinet by using a standard PZ2 screwdriver.

Also featured in the **APC** family are 1 type of wall plate and 2 types of wall bars made of very thick zinc-coated steel and hardened by punched impressions. Wall bars and wall plates feature oval holes which facilitate the correct positioning and give possibility to carry out the horizontal adjustment.

Also available 2 different cover caps: one round version for Ø20 mm hole and one square version for double Ø12 mm holes.

### FEATURES AND BENEFITS

**LOADING CAPACITY:** 65 KG PER PIECE from internal tests.

**AUTOMATIC ASSEMBLY:** especially conceived for the automatic installation on the cabinet.

**WIDE ADJUSTMENT RANGE:** vertical and in-depth adjustments.

**ONE COVER CAP:** only one hole is needed to provide access to all adjustments.

UNI EN 15939:2014 - 65 kg per piece



*Certificates available on request.*



### INSTALLATION UNDER THE CABINET TOP

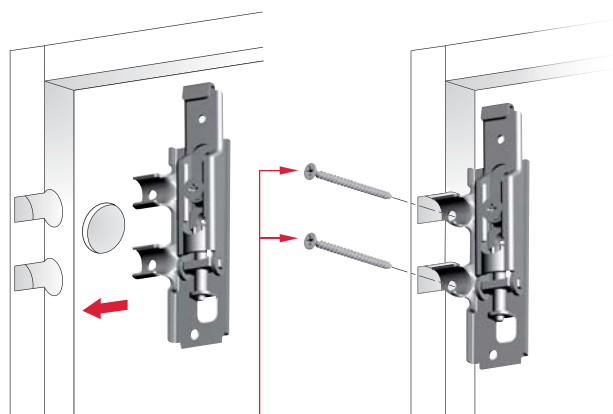

recommended fixing  
countersunk head wood  
screws Ø3x40 mm

### INSTALLATION ON THE WALL

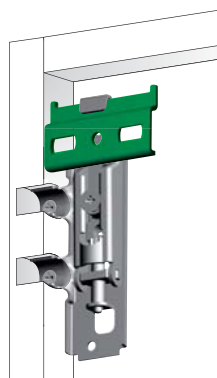

It is the responsibility of the customer:

- to ensure that the wall is of a suitable quality to hold the unit fixing in place.
- to use the proper hardware fittings according to the construction of the wall.

For more specific information, please refer to the **WARNINGS** section at the end of the catalogue.

### COVER CAP INSERTING

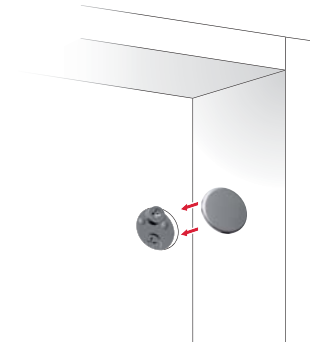

### ADJUSTMENTS

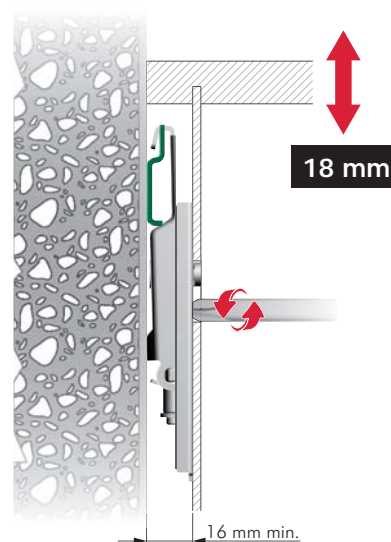
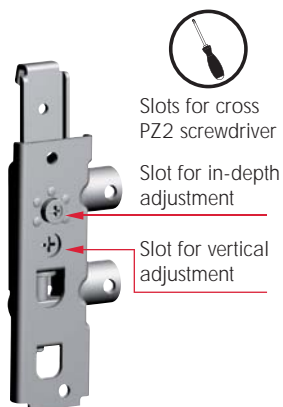

## DRILLING PLAN FOR APC 6 FIXED UNDER THE CABINET TOP

## SIDE PANEL AND SERVICE GAP

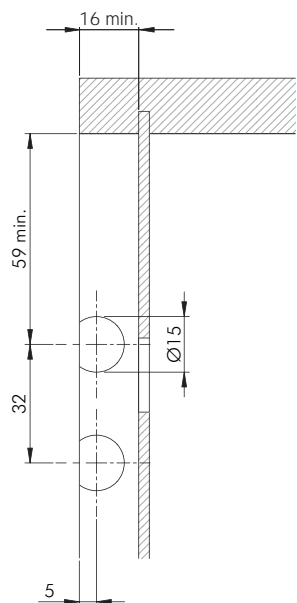

## BACK PANEL

APC cover cap Ø20

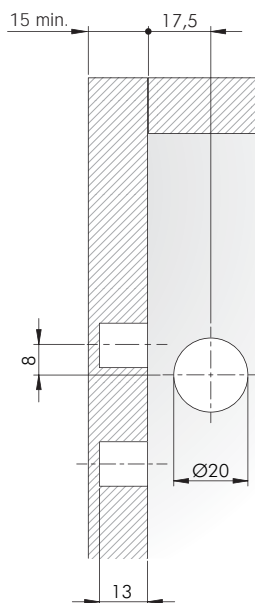

APC cover cap double hole Ø12

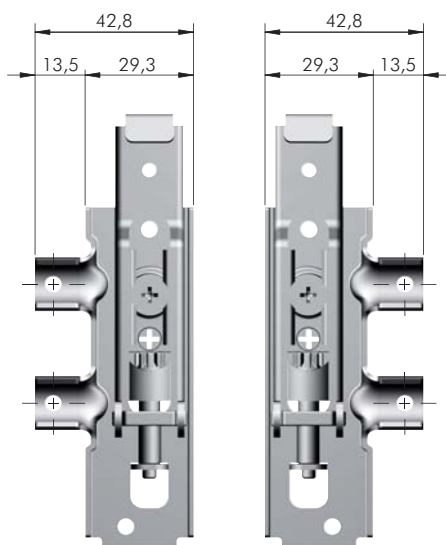
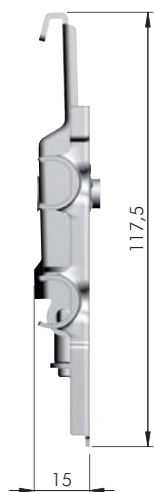
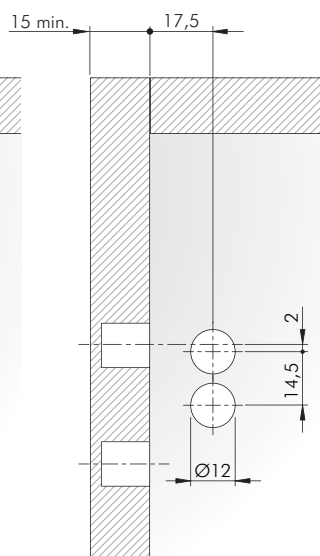

= PZ2



= 100 pcs.



65210020ZN

65210030ZN



## APC 6 FIXING ACCESSORY

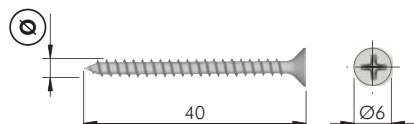

= 500 pcs.



60101270ZN

60101450ZN



3

3,5



PZ1

PZ2



## WPC1 WALL BAR



*Certificates available on request.*

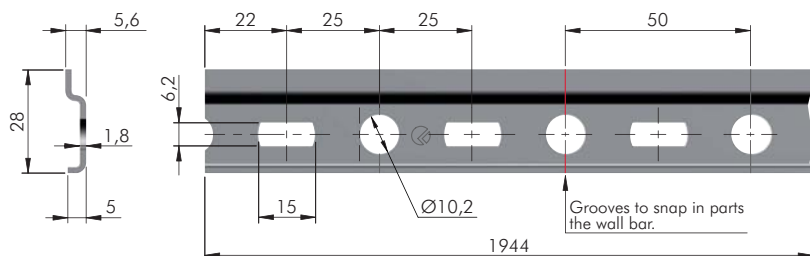

ST

= 20 pcs.



**65240010ZN**

Suitable for service gap from 16 to 18 mm.



## WPC2 WALL PLATE



*Certificates available on request.*

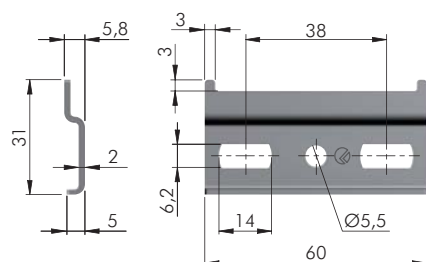

ST

= 100 pcs.



**65230010ZN**

Suitable for service gap from 16 to 18 mm.



## WPC110 WALL PLATE



*Certificates available on request.*

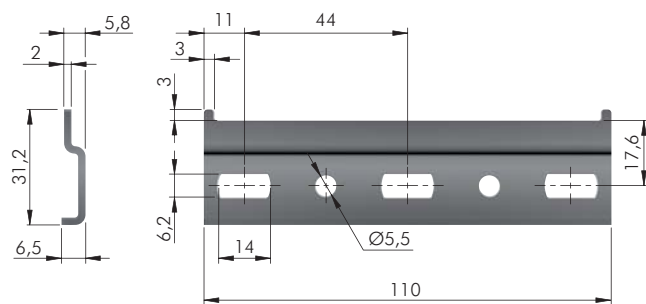

ST

= 100 pcs.



**65230100ZN**

Suitable for service gap from 16 to 20 mm.



## WPC3 WALL BAR



Certificates available on request.

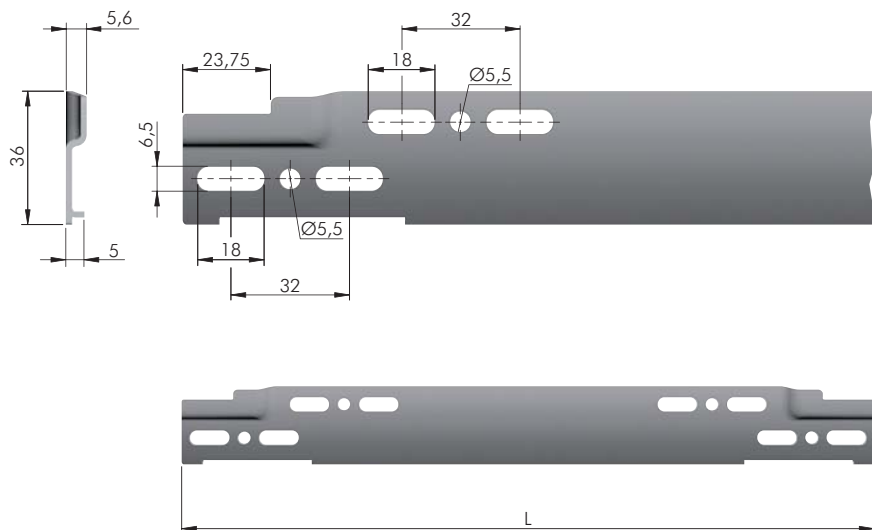

ST

 = 20 pcs.



6525 XXXX ZN

### 6525 XXXX ZN

L = Length of the bar in mm

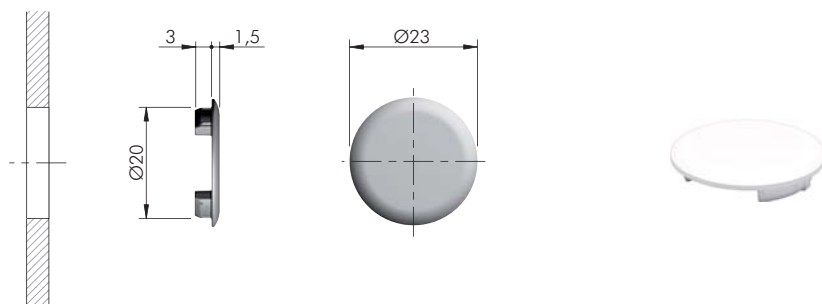

## APC COVER CAP Ø20



= Ø 20 mm



EP

 = 100 pcs.

65270100AB

EE

IJ

YA

YQ

## APC COVER CAP DOUBLE HOLE Ø12

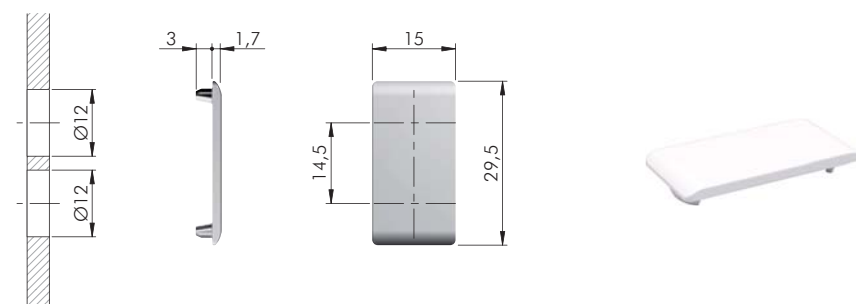

= Ø 12 mm



EP

 = 100 pcs.

65270200AB

EE

IJ

YA

YQ





# SYMBOLS AND FINISHES LEGEND

## SYMBOLS

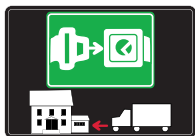

= SHELF SAFELY LOCKED DURING  
TRANSPORTATION AND AT HOME.



= ANTI-TURNOVER LOCKING SYSTEM



= NORMS / PATENTS



= PHILLIPS / POZIDRIV



= WITH BUFFER



= PART NO.



= BLADE SLOT



= WITH MAGNET



= PCS. PER PACKAGE



= COMBI SLOT



= HEXAGONAL SOCKET



= NEWTON



= CAPACITY LOADING



= HEXALOBULAR SOCKET



= FRICTION



= WOOD / GLASS  
THICKNESS



= COUNTERSUNK HEAD



= AUTOMATIC



= HOLE DIAMETER



= PAN HEAD



= DROP DOWN



= DIAMETER



= FLANGE HEAD



= LENGTH



= FLAT HEAD



= STANDARD HINGE



= HEIGHT



= TRILOBULAR SCREW



= KIMANA HINGE



= RIGHT VERSION



= SELF-TAPPING SCREW



= FLAP HINGE



= LEFT VERSION



= EURO THREAD



= WITH SPRING



= SETTING CODE



= METRIC THREAD



= WITHOUT SPRING



= PCS. PER PAD



= PRE-INSERTED SCREW



= REVERSED SPRING



= CUT ON REQUEST



= PRE-INSERTED SCREW  
AND SPREADING BUSH



= SELF ADHESIVE



= WITH FLANGE

NOTE: Printing errors and omissions may exist despite our best efforts to ensure accuracy. We reserve the right to alter specifications without notice.



## MATERIALS

<b>ZA</b> = Zinc Alloy	<b>ST</b> = Steel	<b>HSS</b> = High Speed Steel	<b>BR</b> = Brass	<b>ABS</b> = Acrylonitrile Butadiene Styrene	<b>TPU</b> = Thermoplastic Polyurethane
<b>ZAnk</b> = Nickel-plated Zinc Alloy	<b>STzk</b> = Zinc-plated Steel	<b>AL</b> = Aluminium	<b>WD</b> = Wood	<b>EVA</b> = Ethylene Vinyl Acetate	

<b>EP</b> = <b>ENGINEERING PLASTIC</b>	+ <b>EP</b> = other engineering plastic available on request	<b>SR</b> = <b>SOFT RUBBER</b>	+ <b>SR</b> = other soft rubber available on request
--	--	--------------------------------	--

<b>EPn</b> = Natural Engineering Plastic	<b>EPc</b> = Clear Engineering Plastic	<b>SRn</b> = Natural Soft Rubber
<b>EPw</b> = White Engineering Plastic	<b>EPg</b> = Grey Engineering Plastic	<b>SRw</b> = White Soft Rubber
<b>EPb</b> = Black Engineering Plastic	<b>EPa</b> = Anthracite Engineering Plastic	<b>SRb</b> = Black Soft Rubber



## FINISHES



+ OTHER FINISHES AVAILABLE ON REQUEST

PART NO.	FINISHES	PART NO.	FINISHES	PART NO.	FINISHES
<b>00</b>	Insignificant finish	<b>IF</b>	Grey 7	<b>XE</b>	Inox
<b>AA</b>	Natural	<b>IJ</b>	Light Grey	<b>YA</b>	Nickel-plated
<b>AB</b>	White	<b>IL</b>	Grey 20	<b>YC</b>	Matt Nickel-plated
<b>AE</b>	White 9010	<b>IN</b>	Grey met. 26	<b>YD</b>	Satin-finished Nickel-plated
<b>EA</b>	Black	<b>JG</b>	Aluminium 5	<b>YQ</b>	Black Nickel
<b>EC</b>	Matt Black	<b>JL</b>	Aluminium PE 11	<b>Z9</b>	Black Zinc
<b>EE</b>	Anthracite	<b>JM</b>	Aluminium RAL 9006	<b>ZN</b>	Zinc-plated
<b>EW</b>	Grey 9007	<b>KB</b>	Bright Chrome	<b>ZQ</b>	Bright Gold
<b>FU</b>	Gunmetal	<b>KC</b>	Matt Chrome	<b>ZZ</b>	Clear/Transparent
<b>FV</b>	Gunmetal V52	<b>LD</b>	Brown 8019		
<b>GR</b>	Zamak Raw	<b>RO</b>	Red		
<b>HA</b>	Brass-Plated	<b>UT</b>	T-Met 9007		
<b>HH</b>	Tropicalized	<b>UZ</b>	T-Met		
<b>HL</b>	Raw Brass	<b>WA</b>	Bronzed		
<b>HX</b>	Graphite	<b>WI</b>	Burnished		
<b>IA</b>	Grey	<b>XD</b>	Satin-finished Steel		

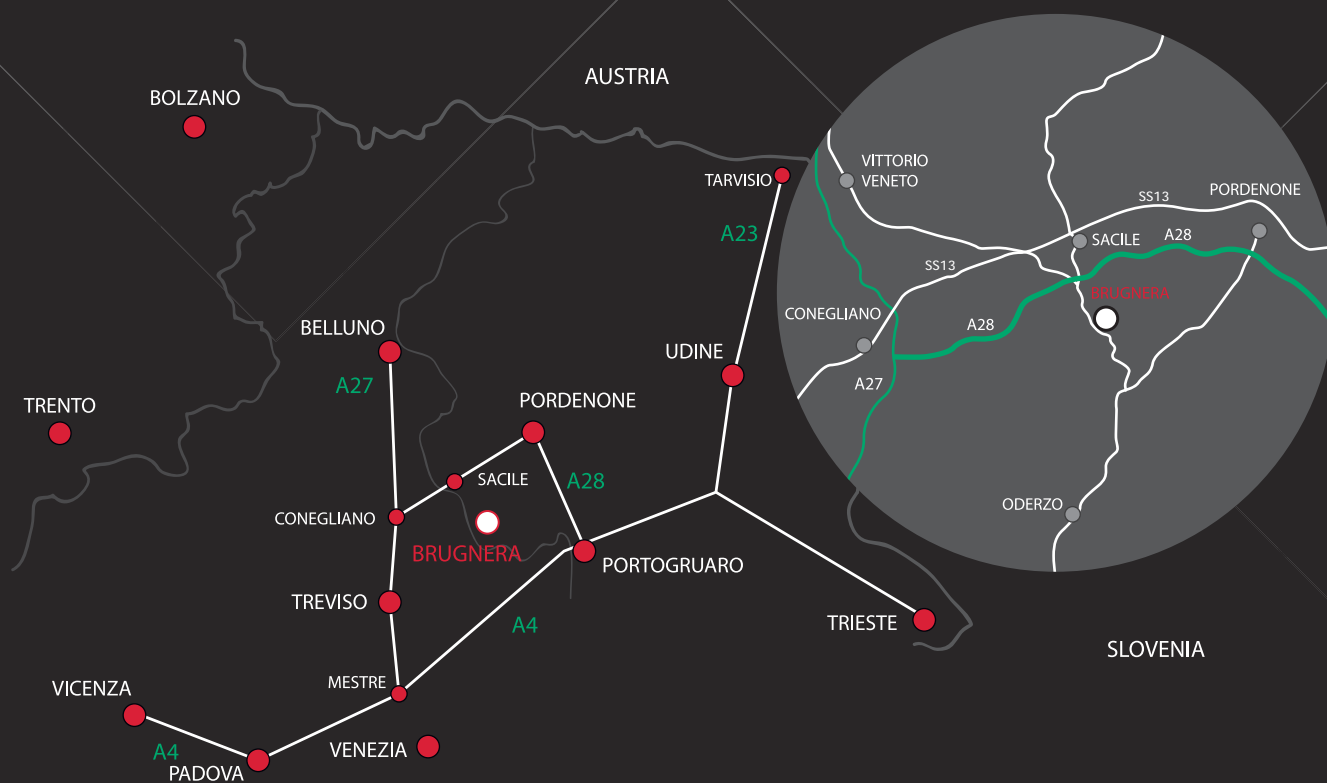

[www.italianaferramenta.com](http://www.italianaferramenta.com)

ITALIANA FERRAMENTA SRL - Viale Europa 17 I - 33070 Brugnara (PN)  
Tel. +39 0434 428211 Fax +39 0434 428242 E-mail: [info@italianaferramenta.it](mailto:info@italianaferramenta.it)